

6,500± SQ. FT. WAREHOUSE SPACE

FOR LEASE

EXCELLENT FOR STORAGE

100% A/C



14000 N Hayden Road | Suite 104 | Scottsdale, Arizona 85260

Presented by

RANDY SHELL

Designated Broker

C 480 694 4100

randy@shellcommercial.com

Shell Commercial Investment Real Estate

O 480 443 3992

F 480 443 3680

www.shellcommercial.com

16410 N 91st Street | Suite 112 | Scottsdale, AZ 85260

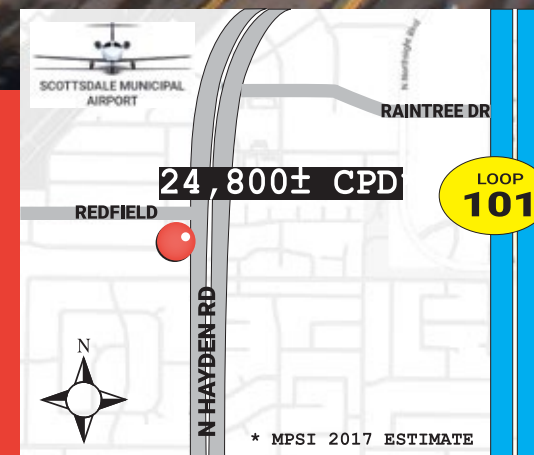

The above is subject to prior sales and leasing. This information has been secured from sources we believe to be reliable, but we make no representation or warranties, expressed or implied as to the accuracy of this information.

14000 N Hayden Road | Suite 104 | Scottsdale, Arizona 85260

DETAILS

- Availability:** ±6,500 Sq. Ft.
- Features:** 100% HVAC Warehouse
- Clear Height:** 26'
- Column Spacing:** 40'
- Loading:** Roll up door
- Power:** 200 AMPS | 277/480 3-phase
- Parking:** 3.0:1,000
- Year Built:** 2007
- Zoning:** I-1, Light Industrial
City of Scottsdale



RANDY SHELL
Designated Broker
C 480 694 4100
randy@shellcommercial.com



14000 N Hayden Road | Suite 104 | Scottsdale, Arizona 85260



- Prime Hayden Road Frontage with High Traffic Exposure
- Building Signage Available
- Quality, Institutional-grade Facility

RANDY SHELL
Designated Broker
C 480 694 4100
randy@shellcommercial.com



14000 N Hayden Road | Suite 104 | Scottsdale, Arizona 85260

FLOOR PLAN

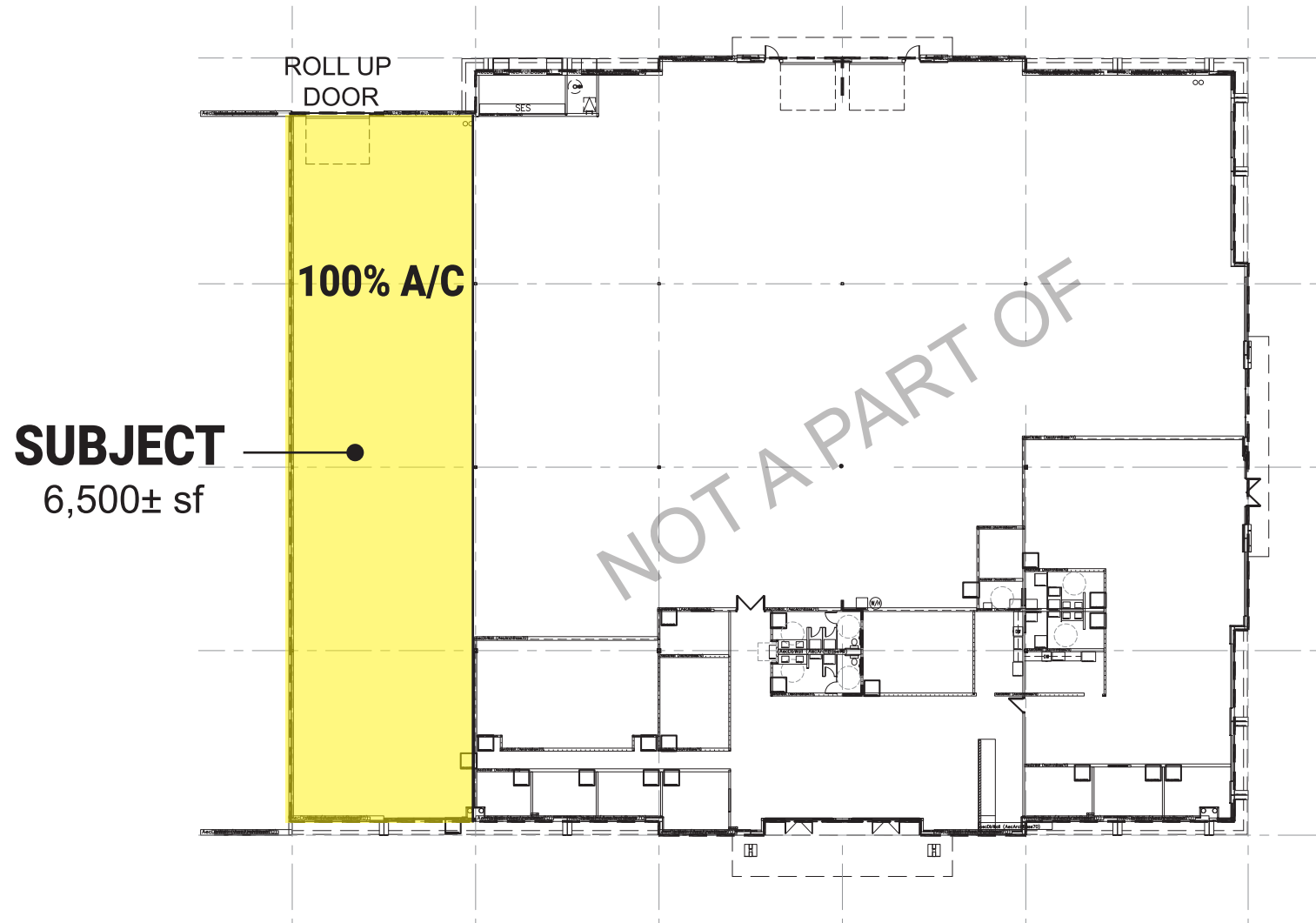

RANDY SHELL
Designated Broker
C 480 694 4100
randy@shellcommercial.com

